

Illuminated pushbutton Ø 19 mm silver contact

82-5151.2114.B001



<https://eao.com/p/82-5151.2114.B001>

Your product:



82-5151.2114.B001 Illuminated pushbutton Ø 19 mm silver contact

FRONT

Front bezel material: Stainless steel

Front bezel shape: flush

MOUNTING

Mounting cut-out: Ø 19 mm

OPERATING-/INDICATION PART

Lens colour: Silver

Lens shape: flush

Illumination colour: Red

Lens optics: opaque

Lens material: Stainless steel

Lens illumination: illuminative

Shape of illumination: Ring

ELECTRICAL CHARACTERISTICS

Rated insulation voltage U_i : 250 V

Contacts: 1 C

Electric strength: 1500 VAC, 50 Hz 1 minute between life terminals and ground

Pollution degree: 2, according to EN IEC 60947-1

Electrical lifetime: 50 000 cycles of operation

Rated Operational Voltage U_e : 250 VAC

Switching voltage and switching current:

| | |
|--|-----------------|
| according to IEC 60947-5-1 (Silver contacts) | |
| Service categorie AC-15 | |
| Voltage | Current |
| 24 VAC | 1 A |
| 35 VAC | 1 A (M12 versio |
| 110 VAC | 1 A |
| 220 VAC | 0.5 A |
| Switch rating DC service categorie DC-13 (Silver contacts) | |
| Voltage | Current |
| 24 VDC | 0.7 A |
| 35 VDC | 0.5 A (M12 vers |
| 110 VDC | 0.2 A |
| 220 VDC | 0.1 A |

| | |
|---------------------------------------|---------|
| according to UL 508 (Silver contacts) | |
| $\cos\phi$ 0,75 ... 0,8 | |
| Voltage | Current |
| 120 VAC | 5 A |
| 240 VAC | 3 A |
| 24 VAC | 1 A |

| | |
|--|---------|
| Thermal current I_{th}: | 5 A |
| Operating voltage: | 24 V DC |

MECHANICAL CHARACTERISTIC

| | |
|-----------------------------|----------------------------------|
| Weight: | 0.018 kg |
| Operating Travel: | ca. 3 mm |
| Operating force: | 4 N ... 7 N |
| Contact material: | Silver |
| Switching action: | Maintained |
| Mechanical lifetime: | 500 000 cycles of operation |
| Terminal: | Soldering terminal, 2.8 x 0.5 mm |
| Switching system: | Snap-action switching element |
| Tightening torque: | 0.5 ... 0.6 Nm |

AMBIENT CONDITION

| | |
|-------------------------------|--|
| Shock resistance: | Max. 500 m / s ² as per IEC 60068-2-27 |
| Operating temperature: | - 30 °C ... + 70 °C |
| Vibration resistance: | 10 ... 500 Hz, amplitude 1.5 mm p-p according to IEC 60068-2-6 |
| Storage temperature: | - 40 °C ... + 80 °C |
| Climate resistance: | Damp heat, 21 days according to IEC 60512-11 |

CERTIFICATE

Approbations: CB, CCC, C UL, UL

Conformities: CE, 2011 / 65 / EC (RoHS), 2014 / 35 / EU (LVD)

OTHER

Kind of illumination: Single-LED

Symbol: ON/OFF

Short Description: Illuminated pushbutton Ø 19 mm silver contact, Maintained, 24 V DC, 1 C, Soldering terminal, 2.8 x 0.5 mm, Stainless steel, Red, ON/OFF, Silver

Mounting cut-outs:

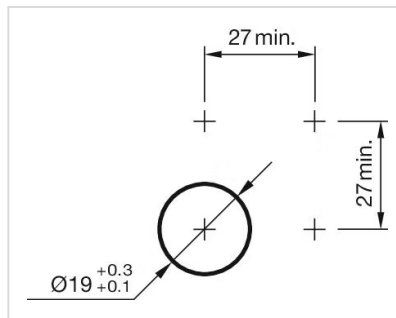

Dimension drawings:

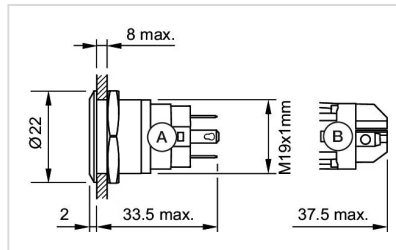

A = Solder terminal
B = Screw terminal

Component layouts:

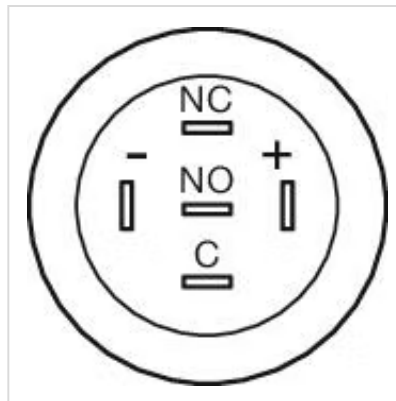

Wiring diagrams:

