

Illuminated pushbutton Ø 19 mm silver contact

82-5551.1114



<https://eao.com/p/82-5551.1114>

Your product:



82-5551.1114

Illuminated pushbutton Ø 19 mm silver contact

FRONT

Front bezel material: Aluminium

MOUNTING

Mounting cut-out: Ø 19 mm

OPERATING-/INDICATION PART

Lens shape: flush

Lens optics: opaque

Shape of illumination: Ring

Lens material: Aluminium

Lens illumination: illuminative

Illumination colour: Red

Lens colour: Nature

ELECTRICAL CHARACTERISTICS

Switching voltage and switching current:

according to IEC 60947-5-1 (Silver contacts)	
Service categorie AC-15	
Voltage	Current
24 VAC	1 A
35 VAC	1 A (M12 versio
110 VAC	1 A
220 VAC	0.5 A
Switch rating DC service categorie DC-13 (Silver contacts)	
Voltage	Current
24 VDC	0.7 A
35 VDC	0.5 A (M12 vers
110 VDC	0.2 A
220 VDC	0.1 A

according to UL 508 (Silver contacts)

cos ϕ 0,75 ... 0,8

Voltage

120 VAC

240 VAC

24 VAC

Current

5 A

3 A

1 A

Contacts:	1 C
Operating voltage:	24 V DC
Thermal current I_{th}:	5 A
Pollution degree:	2, according to EN IEC 60947-1
Rated insulation voltage U_i:	250 V
Electrical lifetime:	50 000 cycles of operation
Rated Operational Voltage U_e:	250 VAC
Electric strength:	1500 VAC, 50 Hz 1 minute between live terminals and ground

MECHANICAL CHARACTERISTIC

Weight:	0.018 kg
Operating force:	4 N ... 7 N
Switching system:	Snap-action switching element
Tightening torque:	0.5 ... 0.6 Nm
Contact material:	Silver
Switching action:	Momentary
Mechanical lifetime:	1 Mio. cycles of operation
Terminal:	Soldering terminal, 2.8 x 0.5 mm
Operating Travel:	ca. 3 mm

AMBIENT CONDITION

Shock resistance:	Max. 500 m / s ² as per IEC 60068-2-27
Operating temperature:	- 30 °C ... + 70 °C
Climate resistance:	Damp heat, 21 days according to IEC 60512-11
Storage temperature:	- 40 °C ... + 80 °C
Vibration resistance:	10 ... 500 Hz, amplitude 1.5 mm p-p according to IEC 60068-2-6

CERTIFICATE

Conformities:	CE, 2011 / 65 / EC (RoHS), 2014 / 35 / EU (LVD)
----------------------	---

Approbations:

CB, CCC, C UL, UL

OTHER

Kind of illumination:

Single-LED

Short Description:

Illuminated pushbutton Ø 19 mm silver contact, Momentary, 24 V DC, 1 C, Soldering terminal, 2.8 x 0.5 mm, Aluminium, Red, Nature

Dimension drawings:

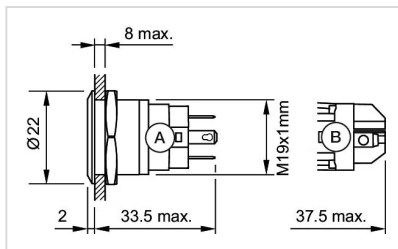

Wiring diagrams:

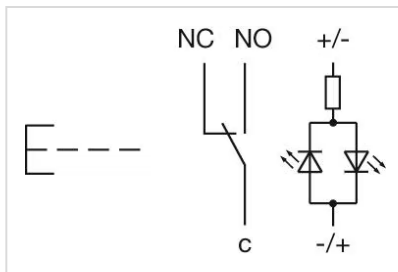

Component layouts:

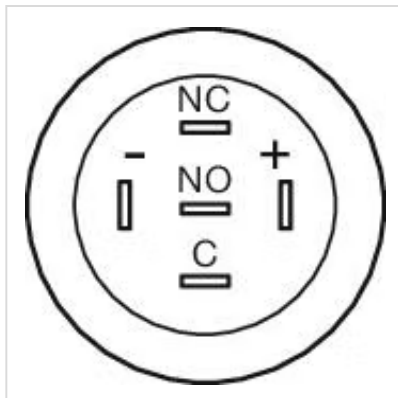

Mounting cut-outs:

