

▲ CIRCUIT DIAGRAM

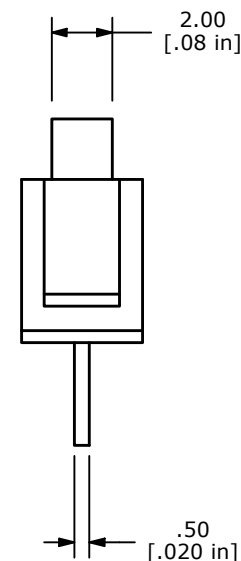

- NOTES:
1. ALL DIMENSIONS IN MM
 2. GENERAL TOLERANCE: X.X = ±0.4
X.XX = ±0.25
 3. TERM. NUMBERS FOR REFERENCE ONLY.
 4. RATING: 0.2A, 30VDC RESISTIVE LOAD
 5. TRAVEL: 2.5mm
 6. OPERATING FORCE: 250 ±100gf
 7. ▲ DENOTES CRITICAL PARAMETER

C	24322	pcb hole size to 1.00mm	6/2/20	MW
B	23246	add Actuator Height	3/2/18	MW
A	17845	New Release	11/6/07	rc
REV	PCR NO	DESCRIPTION	DATE	BY

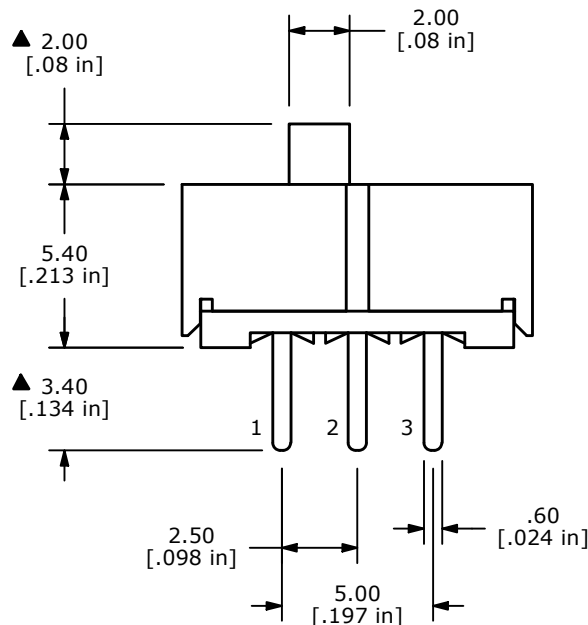

TITLE EG1218A				
SCALE	DATE	DR	DWG	REV
4:1	11/7/2007	rc	P040039	C

THE INFORMATION CONTAINED IN THIS DOCUMENT IS PROPRIETARY TO E-SWITCH AND IS NOT TO BE COPIED OR TRANSFERRED